

24ITB007 280 Door Replacement (Rebid)

Addendum #1 (Revision to Section II - Scope of Services and Questions & Answers)

Issued: 11/20/2023

1 of 2

I. Revision to Section II - Scope of Services:

Section II.A.1, Main Facility Entrance Doors, is hereby deleted in its entirety and replaced with the following:

1. Main Facility Entrance Doors

- Remove and haul away existing electric sliding doors and hardware.
- Provide and install two sets of new electric sliding doors and all necessary hardware, sensors, and controls (new Drawing follows).
- New electric sliding doors shall enable smooth, efficient, and safe entry and exit for high pedestrian traffic.

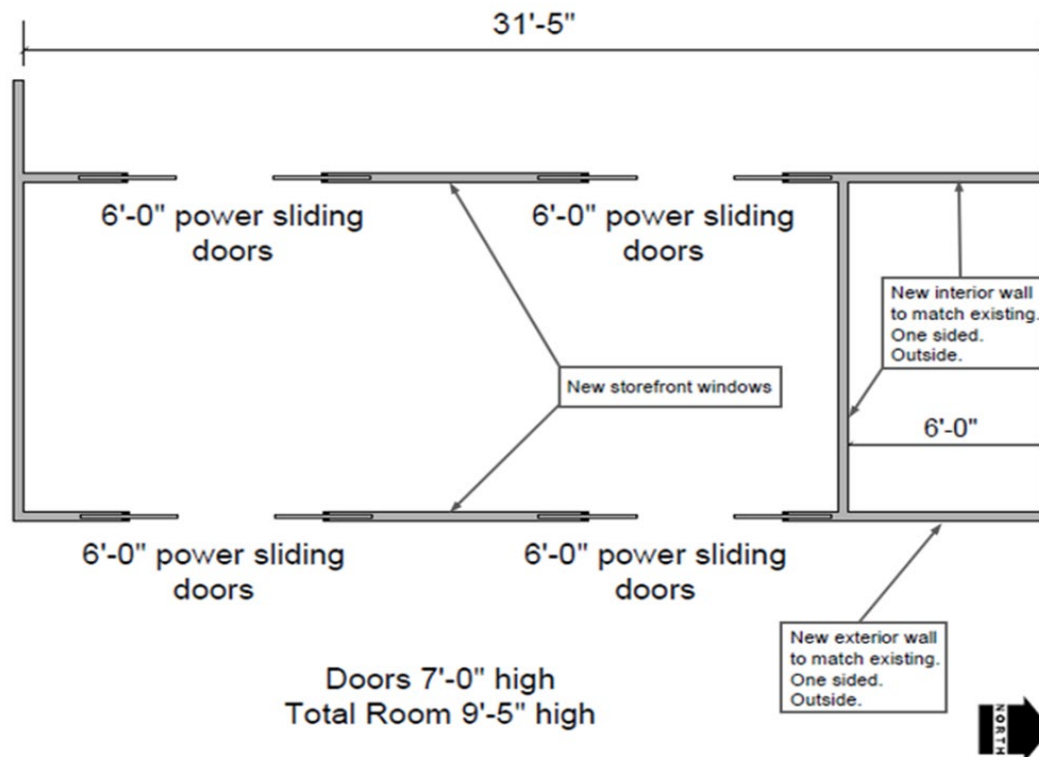

24ITB007 280 Door Replacement (Rebid)**Addendum #1 (Revision to Section II - Scope of Services and Questions & Answers)****Issued: 11/20/2023****2 of 2****II. Written Questions & Answers:**

Question Number	Date Received	Question	Answer
Q1-1	11/17/2023 9:57 AM	Will the bonding requirements be the same (as 24ITB005)?	<i>Refer to 24ITB007 Section IV.A.3.e for bonding requirements (ITB PDF page 7 of 14). The contract will not include liquidated damages (language). The Health District will, however, include language limiting its financial exposure.</i>
Q1-2	11/17/2023 9:57 AM	Will the warranty requirements be the same (as 24ITB005)?	<i>Refer to 24ITB007 Section II.D (ITB PDF page 2 of 14) for warranty requirements.</i>
Q2-1	11/20/2023 9:14 AM	The existing wall appears to be masonry. Please confirm the owner wants a masonry wall “CMU painted blue” for the exterior and steel stud metal framing for the interior with drywall level four finish for one side?	<i>The exterior wall is not CMU but rather tiled and painted "SNHD blue". The interior wall can be steel stud metal framing with drywall finished for one side.</i>
Q2-2	11/20/2023 9:14 AM	The owners new drawing appears to create 6’ x 20’ cavity, will fire suppression be required for this room?	<i>The referenced area has a sprinkler.</i>
Q2-3	11/20/2023 9:14 AM	Please confirm ingress / egress calculation is not impacted by the removal of a portion of the storefront?	<i>Removing a portion of the storefront will not impact the ingress/egress calculation.</i>