



TO: SOUTHERN NEVADA DISTRICT BOARD OF HEALTH DATE: March 31, 2020

RE: *PUBLIC ASSISTANCE COVID-19 TEMPORARY MEDICAL FACILITY*

PETITION #42-20

That the Southern Nevada District Board of Health *approve emergency funding for a temporary medical facility Annex at the current SNHD Main Campus, located at 280 S. Decatur, Las Vegas, Nevada.*

PETITIONERS:

Fermin Leguen, MD, MPH, Acting Chief Health Officer *FL*
Ernest Blazzard, Chief Financial Officer *EB*

DISCUSSION:

Under President Trump's March 13, 2020, national emergency declaration for the coronavirus (COVID-19) pandemic, FEMA's Regional Administrators have been delegated authority to approve requests for temporary medical facilities for the duration of the Secretary of Health and Human Services' declaration of a Public Health Emergency for COVID-19. In accordance with section 502 of the Robert T. Stafford Disaster Relief and Emergency Assistance Act, eligible emergency protective measures taken to respond to the COVID-19 emergency at the direction or guidance of state, local, tribal, and territorial public health officials may be reimbursed under Category B of FEMA's Public Assistance program. FEMA recognizes that temporary medical facilities may be necessary in this Public Health Emergency to save lives, to protect property and public health, and to ensure public safety, as well as to lessen or avert the threat of a catastrophe. States, tribes and territories should work with their regional administrators for approval of temporary medical facilities and procure the necessary support services needed to meet the needs of the



public health emergency. The following criteria must be considered before setting up temporary medical facilities and support services:

- The temporary medical facilities must be at the direction of and documented through an official order signed by a state, local, tribal, or territorial public health official.
- Any approval is limited to that which is reasonable and necessary to address the public health needs of the event and should not extend beyond the duration of the Public Health Emergency.
- Applicants must follow FEMA's Procurement Under Grants Conducted [Under Exigent or Emergency Circumstances](#) guidance and include a termination for convenience clause in their contracts
- Prior to approval, the applicant must provide an analysis of the implementation options that were considered and a justification for the option selected.
- The funding for temporary medical facilities to meet the needs of the Public Health Emergency cannot be duplicated by another federal agency, including the U.S. Department of Health and Human Services or Centers for Disease Control and Prevention.
- Applicable Environmental and Historic Preservation laws, regulations, and executive orders apply and must be adhered to as a condition of assistance.
- Please refer to attached diagrams and documentation for further information.

FUNDING:

The total Cost estimate will be \$3,000,000. FEMA will reimburse 75% of the costs of the Annex. The District's portion will be between \$750,000 and \$800,000, paid through the General Fund, or other available Fund as directed by the Board of Health. Additionally, other government agencies may be asked to share the District's cost portion.



**APPROVED WITH AMENDED LANGUAGE
BY BOARD OF HEALTH
MARCH 31, 2020
SEE PAGE 1 - AMENDED PETITION**

TO: SOUTHERN NEVADA DISTRICT BOARD OF HEALTH DATE: March 31, 2020

RE: *PUBLIC ASSISTANCE COVID-19 NON-CONGREGATE SHELTERING*

PETITION #42-20

That the Southern Nevada District Board of Health *approve emergency funding for non-congregate sheltering construction Annex at the current SNHD Main Campus, located at 280 S. Decatur, Las Vegas, Nevada.*

PETITIONERS:

Fermin Leguen, MD, MPH, *Acting Chief Health Officer* *FL*
Ernest Blazzard, *Chief Financial Officer* *EB*

DISCUSSION:

Under President Trump's March 13, 2020, national emergency declaration for the coronavirus (COVID-19) pandemic, FEMA's Regional Administrators have been delegated authority to approve requests for non-congregate sheltering for the duration of the Secretary of Health and Human Services' declaration of a Public Health Emergency for COVID-19. In accordance with section 502 of the Robert T. Stafford Disaster Relief and Emergency Assistance Act, eligible emergency protective measures taken to respond to the COVID-19 emergency at the direction or guidance of state, local, tribal, and territorial public health officials may be reimbursed under Category B of FEMA's Public Assistance program. FEMA recognizes that non-congregate sheltering may be necessary in this Public Health Emergency to save lives, to protect property and public health, and to ensure public safety, as well as to lessen or avert the threat of a catastrophe. States, tribes and territories should work with their regional administrators for approval of non-congregate sheltering and procure the necessary support services needed to meet the needs of the



public health emergency. The following criteria must be considered before setting up non-congregate sheltering and support services:

- The non-congregate sheltering must be at the direction of and documented through an official order signed by a state, local, tribal, or territorial public health official.
- Any approval is limited to that which is reasonable and necessary to address the public health needs of the event and should not extend beyond the duration of the Public Health Emergency.
- Applicants must follow FEMA's Procurement Under Grants Conducted [Under Exigent or Emergency Circumstances](#) guidance and include a termination for convenience clause in their contracts
- Prior to approval, the applicant must provide an analysis of the implementation options that were considered and a justification for the option selected.
- The funding for non-congregate sheltering to meet the needs of the Public Health Emergency cannot be duplicated by another federal agency, including the U.S. Department of Health and Human Services or Centers for Disease Control and Prevention.
- Applicable Environmental and Historic Preservation laws, regulations, and executive orders apply and must be adhered to as a condition of assistance.
- Please refer to attached diagrams and documentation for further information.

FUNDING:

The total Cost estimate will be \$3,000,000. FEMA will reimburse 75% of the costs of the Annex. The District's portion will be between \$750,000 and \$800,000, paid through the General Fund, or other available Fund as directed by the Board of Health. Additionally, other government agencies may be asked to share the District's cost portion.



FEMA (2)

Navigation

Search

Languages

News Releases (/news-releases)

Fact Sheets (/fact-sheets)

News Desk Contacts (/media-contacts)

Coronavirus (COVID-19) Pandemic: Eligible Emergency Protective Measures

Release date: March 19, 2020

Release Number: FACT SHEET

Consistent with the President's national emergency declaration for the coronavirus (COVID-

19) pandemic on March 13, 2020, FEMA urges officials to, without delay, take appropriate actions that are necessary to protect public health and safety pursuant to public health guidance and conditions and capabilities in their jurisdictions. FEMA provides the following guidance on the types of emergency protective measures that may be eligible under FEMA's Public Assistance Program in accordance with the COVID-19 Emergency Declaration in order to ensure that resource constraints do not inhibit efforts to respond to this unprecedented disaster.

FEMA Public Assistance Program

In accordance with section 502 of the Robert T. Stafford Disaster Relief and Emergency Assistance Act, 42 U.S.C. 5121-5207 (the "Stafford Act"), eligible emergency protective measures taken to respond to the COVID-19 emergency at the direction or guidance of public health officials may be reimbursed under Category B of FEMA's Public Assistance program. FEMA will not duplicate assistance provided by the U.S. Department of Health and Human Services (HHS), (<http://www.hhs.gov/>) to include the Centers for Disease Control and Prevention (CDC), (<http://www.cdc.gov/>), or other federal agencies.

State, territorial, tribal, and local government entities and certain private non-profit organizations are eligible to apply for Public Assistance (<https://www.fema.gov/public-assistance-local-state-tribal-and-non-profit>). FEMA assistance will be provided at a 75 percent federal cost share. This assistance will require execution of a FEMA-State/Tribal/Territory Agreement, as appropriate, and execution of an applicable emergency plan. Local governments and other eligible PA applicants will apply through their respective state, tribal or territorial jurisdictions.

Eligible Assistance

Under the COVID-19 Emergency Declaration described above, FEMA may provide assistance for emergency protective measures including, but not limited to, the following, if not funded by the HHS/CDC or other federal agency. While some activities listed may be eligible for funding through HHS/CDC, final reimbursement determinations will be coordinated by HHS and FEMA. FEMA will not duplicate any assistance provided by HHS/CDC:

- Management, control and reduction of immediate threats to public health and safety:

- Emergency Operation Center costs
- Training specific to the declared event
- Disinfection of eligible public facilities
- Technical assistance to state, tribal, territorial or local governments on emergency management and control of immediate threats to public health and safety
- Emergency medical care:
 - Non-deferrable medical treatment of infected persons in a shelter or temporary medical facility
 - Related medical facility services and supplies
 - Temporary medical facilities and/or enhanced medical/hospital capacity (for treatment when existing facilities are reasonably forecasted to become overloaded in the near term and cannot accommodate the patient load or to quarantine potentially infected persons)
 - Use of specialized medical equipment
 - Medical waste disposal
 - Emergency medical transport
- Medical sheltering (e.g. when existing facilities are reasonably forecasted to become overloaded in the near future and cannot accommodate needs)
 - All sheltering must be conducted in accordance with standards and/or guidance approved by HHS/CDC and must be implemented in a manner that incorporates social distancing measures
 - Non-congregate medical sheltering is subject to prior approval by FEMA and is limited to that which is reasonable and necessary to address the public health needs of the event, is pursuant to the direction of appropriate public health officials and does not extend beyond the duration of the Public Health Emergency
- □ Household pet sheltering and containment actions related to household pets in accordance with CDC guidelines
- □ Purchase and distribution of food, water, ice, medicine, and other consumable supplies, to include personal protective equipment and hazardous material suits
- □ Movement of supplies and persons
- □ Security and law enforcement
- □ Communications of general health and safety information to the public
- □ Search and rescue to locate and recover members of the population requiring assistance
- □ Reimbursement for state, tribe, territory and/or local government force account overtime costs

More Information

Further information about eligible emergency protective measures can be found in the [Public Assistance Program and Policy Guide](https://www.fema.gov/media-library-data/1525468328389-4a038bbef9081cd7dfe7538e7751aa9c/PAPPG_3.1_508_FINAL_5-4-2018.pdf), (https://www.fema.gov/media-library-data/1525468328389-

4a038bbef9081cd7dfe7538e7751aa9c/PAPPG_3.1_508_FINAL_5-4-2018.pdf) FP 104-009-2 (April 2018).

For more information, visit the following federal government websites:

- [Coronavirus \(COVID-19\) \(CDC\)](https://www.cdc.gov/coronavirus/2019-nCoV/index.html), (https://www.cdc.gov/coronavirus/2019-nCoV/index.html)
- [Centers for Medicare & Medicaid Services](https://www.cms.gov/) (https://www.cms.gov/)

Related Content:

[La Pandemia del Coronavirus \(COVID-19\): Medidas de Protección en Emergencias Elegibles \(/node/357845\)](#)

Last Updated: March 20, 2020 - 08:39

Related State(s):

[Headquarters \(/fema-regions/headquarters\)](#)

 Share This Page.



(https://www.facebook.com/sharer/sharer.php?u=https://www.fema.gov/news-release/2020/03/19/coronavirus-covid-19-pandemic-eligible-emergency-protective-measures (https://twitter.com/intent/tweet?text=Coronavirus+%28COVID-19%29+Pandemic%3A+Eligible+Emergency+Protective+Measures&url=https://www.fema.gov/news-release/2020/03/19/coronavirus-covid-19-pandemic-eligible-emergency-protective-measures&via=fema)  (https://www.linkedin.com/shareArticle?mini=true&url=https://www.fema.gov/news-release/2020/03/19/coronavirus-covid-19-pandemic-eligible-emergency-protective-measures&title=Coronavirus (COVID-19) Pandemic: Eligible Home (/) About Us (/about-agency) Download Plug-ins (/download-plug-ins) Doing Business with FEMA (/industry-liason-program) Privacy Policy (/privacy-policy)  (https://plus.google.com/share?url=https://www.fema.gov/news-release/2020/03/19/coronavirus-covid-19-pandemic-eligible-emergency-protective-measures/)  (http://www.tumblr.com/share/link?url=https://www.fema.gov/news-release/2020/03/19/coronavirus-covid-19-pandemic-eligible-emergency-protective-measures&title=Coronavirus (COVID-19) Pandemic: Eligible Emergency Protective Measures&description=Coronavirus (COVID-19) Pandemic: Eligible Emergency Protective Measures&url=https://www.fema.gov/news-release/2020/03/19/coronavirus-covid-19-pandemic-eligible-emergency-protective-measures&via=fema)  (https://twitter.com/intent/tweet?text=Coronavirus+%28COVID-19%29+Pandemic%3A+Eligible+Emergency+Protective+Measures&url=https://www.fema.gov/news-release/2020/03/19/coronavirus-covid-19-pandemic-eligible-emergency-protective-measures&via=fema)  (mailto:https://www.fema.gov/news-release/2020/03/19/coronavirus-covid-19-pandemic-eligible-emergency-protective-measures&title=Coronavirus (COVID-19) Pandemic: Eligible Emergency Protective Measures&description=Coronavirus (COVID-19) Pandemic: Eligible Emergency Protective Measures&url=https://www.fema.gov/news-release/2020/03/19/coronavirus-covid-19-pandemic-eligible-emergency-protective-measures&via=fema)                                                                                                                                                                                                                                                                                                                                                                                                             

PUBLIC ASSISTANCE COVID-19 NON-CONGREGATE SHELTERING DELEGATION OF AUTHORITY BULLETIN #4 – 3/26/20

Under President Trump's March 13, 2020, national emergency declaration for the coronavirus (COVID-19) pandemic, FEMA's Regional Administrators have been delegated authority to approve requests for non-congregate sheltering for the duration of the Secretary of Health and Human Services' declaration of a Public Health Emergency for COVID-19.

In accordance with section 502 of the Robert T. Stafford Disaster Relief and Emergency Assistance Act, eligible emergency protective measures taken to respond to the COVID-19 emergency at the direction or guidance of state, local, tribal, and territorial public health officials may be reimbursed under Category B of FEMA's Public Assistance program.

FEMA recognizes that non-congregate sheltering may be necessary in this Public Health Emergency to save lives, to protect property and public health, and to ensure public safety, as well as to lessen or avert the threat of a catastrophe. States, tribes and territories should work with their regional administrators for approval of non-congregate sheltering and procure the necessary support services needed to meet the needs of the public health emergency. The following criteria must be considered before setting up non-congregate sheltering and support services:

- The non-congregate sheltering must be at the direction of and documented through an official order signed by a state, local, tribal, or territorial public health official.
- Any approval is limited to that which is reasonable and necessary to address the public health needs of the event and should not extend beyond the duration of the Public Health Emergency.
- Applicants must follow FEMA's Procurement Under Grants Conducted Under Exigent or Emergency Circumstances guidance and include a termination for convenience clause in their contracts
- Prior to approval, the applicant must provide an analysis of the implementation options that were considered and a justification for the option selected.
- The funding for non-congregate sheltering to meet the needs of the Public Health Emergency cannot be duplicated by another federal agency, including the U.S. Department of Health and Human Services or Centers for Disease Control and Prevention.
- Applicable Environmental and Historic Preservation laws, regulations, and executive orders apply and must be adhered to as a condition of assistance.



This is \$2.8¹
 There is a lease option to buy
 \$200K/month x 6 months, then \$1.8¹ to purchase; if we don't buy all then it is \$100,000/month x 10 months, it includes maintenance tunnel
 I imagined a generator, other we'd hook it up to the building's electric power
 7,200 sq ft

ADD 1

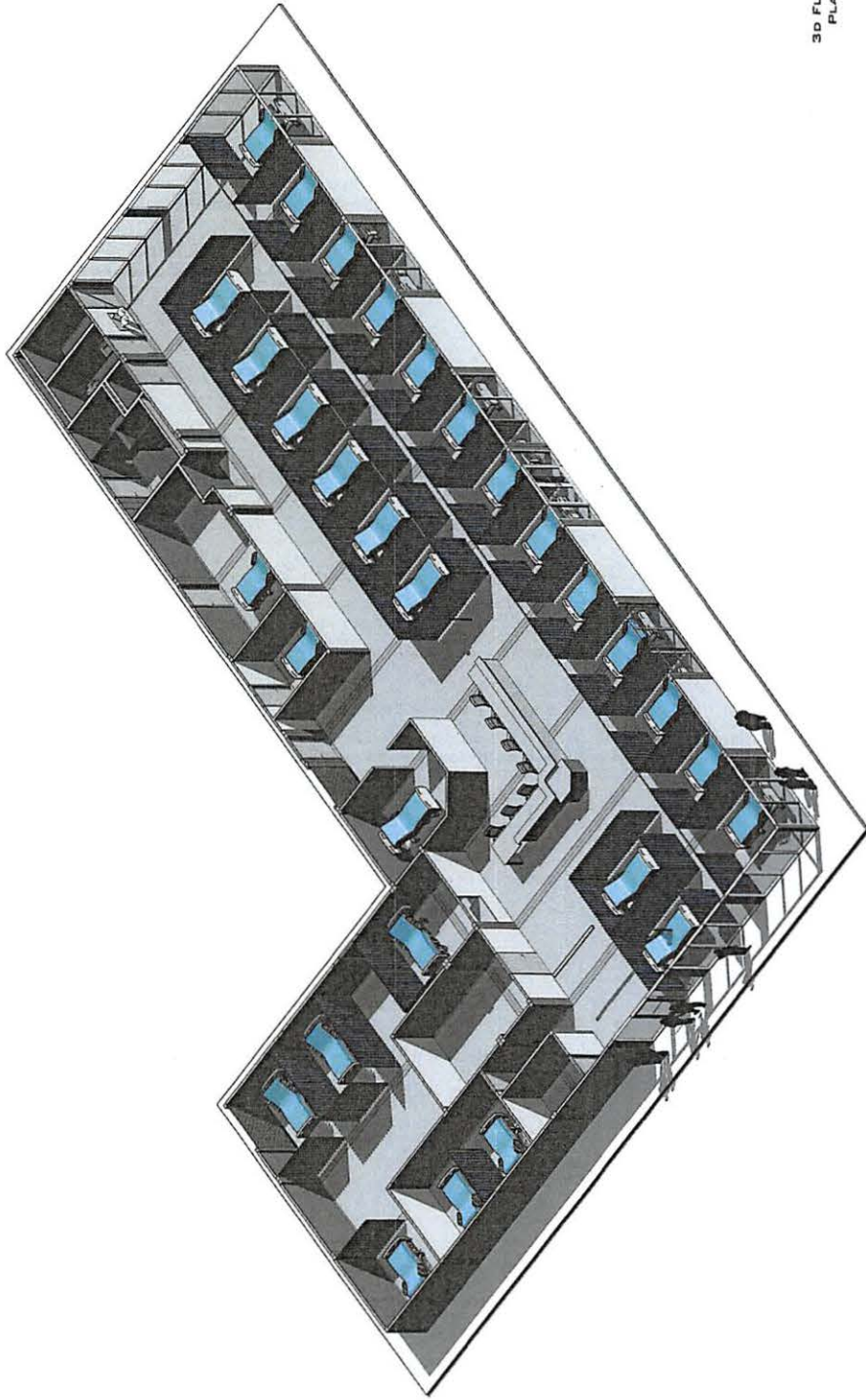

3D FLOOR
PLAN

A002

B.C.U

Bio Containment Unit 6-TR



ModTruss INC

10 x 10 ft

Technical data sheet

Single Module

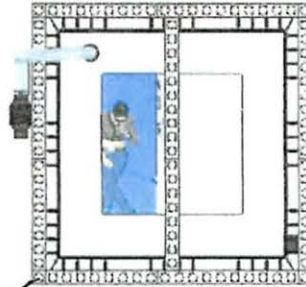
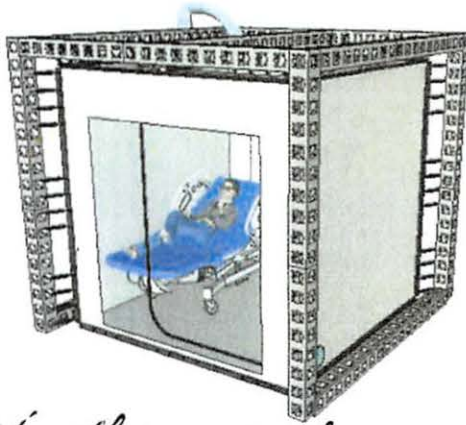

Ministry thinking about 5 units (BCU)

Donning Doffing Configuration

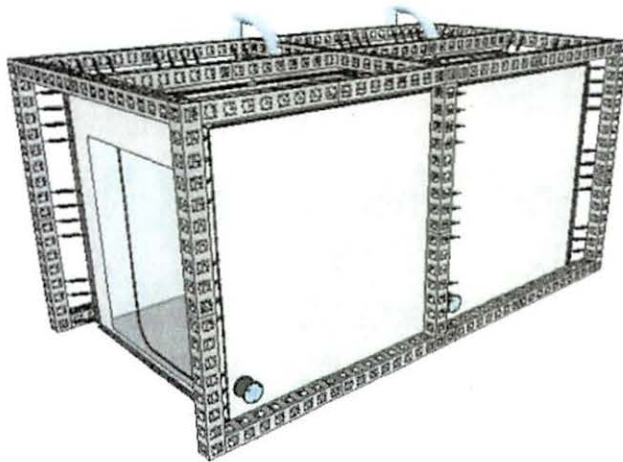

TO Order: call you local
ModTruss Dealer or

Call: 01.844.663.8787
Email: info@modtruss.com

ModTruss Inc
33 Sheboygan St.
Fond Du Lac, WI
54935 USA
www.ModTruss.com

*\$20K a unit, all
inclusive.*

Multi room expansion