

DEPARTMENT OF PUBLIC WORKS

Mayor:
CAROLYN G. GOODMAN

City Council:
CEDRIC CREAR
BRIAN KNUDSEN
VICTORIA SEAMAN
OLIVIA DIAZ
FRANCIS ALLEN-PALENSKE
NANCY E. BRUNE

City Manager:
JORGE CERVANTES, P.E., P.T.O.E.

Director of Public Works:
MIKE JANSSEN, P.E., P.T.O.E.

City Engineer:
ROSA A. CORTEZ, P.E.



SNHD
BSL3 LAB

50% DESIGN DOCUMENTS
10 MAY 2024

Reviewed By:

CLV CITY ENGINEER _____ DATE _____

CLV PROJECT MANAGER _____ DATE _____

CLV CITY TRAFFIC ENGINEER _____ DATE _____

CLV CONSTRUCTION MANAGER _____ DATE _____

CLARK COUNTY REGIONAL FLOOD CONTROL DISTRICT _____ DATE _____

REGIONAL TRANSPORTATION COMMISSION OF SOUTHERN NEVADA _____ DATE _____
RTC PROJECT # _____

SOUTHWEST GAS CORPORATION _____ DATE _____

CENTRAL TELEPHONE COMPANY d/b/a CENTURYLINK _____ DATE _____
THE AFFIXED CENTURYLINK NEVADA APPROVAL DOES NOT ASSUME OR GUARANTEE LIABILITY FOR KNOWN OR UNKNOWN CONFLICTS WITH EXISTING OR PROPOSED IMPROVEMENTS. RESOLUTION OF ANY CONFLICT WILL BE ACCOMPLISHED PURSUANT TO LOCAL ORDINANCES, NEVADA REVISED STATUTES AND/OR PUBLIC UTILITY COMMISSION STANDARD REGULATIONS.

COX COMMUNICATIONS LAS VEGAS, INC. _____ DATE _____

NV ENERGY - DISTRIBUTION _____ DATE _____
NV ENERGY ACKNOWLEDGES THAT WE HAVE RECEIVED YOUR PLANS AND WILL PROVIDE SERVICE TO ALL ELECTRICAL NEEDS ASSOCIATED WITH THIS PROJECT. NV ENERGY RESERVES THE RIGHT TO ADDRESS ANY EXISTING OR FUTURE CONFLICTS ONCE THE FINAL DESIGN IS COMPLETED. THE NEW SERVICE AND THE RESOLUTION OF ANY CONFLICTS WILL BE ACCOMPLISHED PURSUANT TO THE NEVADA PUBLIC UTILITY COMMISSION'S RULES AND REGULATIONS.

NV ENERGY - TRANSMISSION _____ DATE _____

APPROVED FOR CONSTRUCTION

LAS VEGAS VALLEY WATER DISTRICT PLANNING AND ENGINEERING SERVICES
PROJECT NO. # _____ DATE: 5/10/2024
SHEETS: #####

THE SIGNATURE ABOVE ACKNOWLEDGES THAT THE UTILITY COMPANY REPRESENTATIVE HAS REVIEWED THE PLANS, AND THAT TO THE BEST OF HIS OR HER KNOWLEDGE THE UTILITY LINES ARE SHOWN IN THE CORRECT LOCATIONS AND ARE THE CORRECT SIZES. WHILE SUCH DATA HAS BEEN COLLECTED WITH REASONABLE CARE, THERE IS NO EXPRESSED OR IMPLIED GUARANTEE THAT THE LOCATIONS ARE EXACT. THE CONTRACTOR SHALL BEAR THE RESPONSIBILITY OF OBTAINING THE ACTUAL FIELD LOCATIONS.

NO.	DATE	SHEET	REVISIONS

PREPARED BY: **latitude 33** PLANNING & ENGINEERING
10731 Travena Street, San Diego, CA 92131
Tel: 608-91-6633
LATITUDE 33 PLANNING AND ENGINEERING

NOT FOR CONSTRUCTION

TITLE: SNHD BSL3 LAB COVER SHEET
SHEET

PREPARED FOR: CITY OF LAS VEGAS
DATE: 5/10/2024
DESIGNED BY: KC
DRAWN BY: KC
CHECKED BY: VB
SUBMITTAL STAGE: 50% DD

DRAWING NO. CV 1 8
###

H:\1920\0430 - EWING COLE - SNHD BSL3 LAB VEGAS ENGINEERING\AN\PUBLIC IMPROVEMENT PLANS\G:\SNHD LAB\PUBLIC IMP - G SHEETS.DWG 5/10/24

CITY OF LAS VEGAS GENERAL NOTES

- 1. ALL CONSTRUCTION AND MATERIALS SHALL BE IN ACCORDANCE WITH THE "UNIFORM STANDARD SPECIFICATIONS FOR PUBLIC WORKS CONSTRUCTION OFF-SITE IMPROVEMENTS, CLARK COUNTY AREA NEVADA", LATEST ISSUE...

REVISED MAY 10, 2021 (CPM VERSION)

CITY OF LAS VEGAS GRADING NOTES

- 1. IN THE EVENT THAT ANY UNFORESEEN CONDITIONS NOT COVERED BY THESE NOTES ARE ENCOUNTERED DURING GRADING OPERATIONS, THE OWNER/ENGINEER SHALL BE IMMEDIATELY NOTIFIED FOR DIRECTION.

REVISED APRIL 13, 2015 (CPM VERSION)

CITY OF LAS VEGAS SEWER NOTES

- 1. ALL CONSTRUCTION AND MATERIALS SHALL BE IN ACCORDANCE WITH THE LATEST EDITION OF THE DESIGN AND CONSTRUCTION STANDARDS FOR WASTEWATER COLLECTION SYSTEMS AND THE UNIFORM STANDARD SPECIFICATIONS FOR PUBLIC WORKS' CONSTRUCTION OFF-SITE IMPROVEMENTS, CLARK COUNTY AREA, NEVADA, AS AMENDED...

REVISED JANUARY 13, 2015

CITY OF LAS VEGAS STREET LIGHT NOTES

- 1. ALL STREET LIGHTING INSTALLATIONS SHALL BE IN ACCORDANCE WITH THE STREET LIGHTING PLANS, THE "UNIFORM STANDARD SPECIFICATION FOR PUBLIC WORKS CONSTRUCTION OFF-SITE IMPROVEMENTS, CLARK COUNTY AREA, NEVADA", LATEST REVISION (USS), AND THE "UNIFORM STANDARD DRAWINGS FOR PUBLIC WORKS CONSTRUCTION OFF-SITE IMPROVEMENTS, CLARK COUNTY AREA, NEVADA" (USD), LATEST REVISION.

CITY OF LAS VEGAS STREET LIGHT NOTES - CONTINUED

- 12. ALL STREET LIGHTING AND TRAFFIC SIGNAL EQUIPMENT REMOVED AND / OR DESIGNATED TO BE SALVAGED SHALL BE DELIVERED BY THE CONTRACTOR TO THE APPROPRIATE CLV SERVICE YARD WITH A MEANS TO UNLOAD, A MINIMUM 24-HOUR NOTICE OF DELIVERY IS REQUIRED.

REVISED May 19, 2020 (CPM VERSION)

CITY OF LAS VEGAS TRAFFIC NOTES

- 1. ALL CONSTRUCTION SIGNING, BARRICADING, AND TRAFFIC DELINEATION SHALL CONFORM TO THE "MANUAL ON UNIFORM TRAFFIC CONTROL DEVICES", LATEST EDITION.

REVISED JUNE 4, 2018

CITY OF LAS VEGAS FIBER OPTIC NETWORK NOTES

- 1. RIGHT OF WAY 80 FEET OR WIDER, FURNISH AND INSTALL TWO 4-INCH PVC CONDUITS WITH #8 AWG THW GREEN BOND GROUNDS ON BOTH SIDES OF THE ROADWAY.

CITY OF LAS VEGAS FIBER OPTIC NETWORK NOTES - CONTINUED

- 12. ETHERNET SWITCH WILL BE PROVIDED BY THE OWNER AFTER CONSTRUCTION HAS STARTED. THE CONTRACTOR WILL BE REQUIRED TO PICK UP AND INSTALL THE SWITCH IN EACH TELECOM CABINET AS SHOWN ON THE CONTRACT DRAWINGS AND AS DIRECTED BY THE ENGINEER.

REVISED FEB 18, 2020

CITY OF LAS VEGAS FIRE AND RESCUE NOTES

- 1. ALL WORK SHALL BE DONE IN STRICT ACCORDANCE WITH THE LAS VEGAS FIRE AND RESCUE ADOPTED FIRE CODE ORDINANCE #6631 FOR HYDRANT SPECIFICATIONS AND HYDRANT INSTALLATION SPECIFICATIONS.

REVISED FEBRUARY 4, 2019

LVVWD STANDARD NOTES

- 1. NO WORK SHALL BEGIN UNTIL THE WATER PLANS HAVE BEEN APPROVED FOR CONSTRUCTION BY THE LVVWD. FOLLOWING WATER PLAN APPROVAL, NOTICE SHALL BE GIVEN TO THE LVVWD COMMUNICATION SUPPORT CENTER (258-7171) TWO (2) WORKING DAYS PRIOR TO THE START OF CONSTRUCTION. FOR FUTURE INSPECTIONS, NOTICE MUST BE GIVEN BY 2:00 P.M. THE BUSINESS DAY PRIOR TO THE REQUESTED LVVWD INSPECTION.

APPROVED FOR CONSTRUCTION
LAS VEGAS VALLEY WATER DISTRICT PLANNING AND ENGINEERING SERVICES
PROJECT NO. 00000 FIRST APPROVED DATE: 01-01-2018

5/10/24 H:\1930\0430 - EWING COLE - SNHD\BLS3 LAB VEGAS ENGINEERING\AN\PUBLIC IMPROVEMENT\PLANS\01 SNHD LAB PUBLIC IMP - G SHEETS.DWG

PREPARED BY: latitude33 PLANNING & ENGINEERING
GENERAL NOTES
CITY OF LAS VEGAS
DATE: 5/10/2024
DESIGNED BY: KC
DRAWN BY: KC
CHECKED BY: VB

CLV TRAFFIC SIGNAL NOTES

- ALL WORK PERFORMED ON ANY TRAFFIC SIGNAL COMPONENT MUST BE UNDER THE DIRECT ON-SITE SUPERVISION OF AN IMSA CERTIFIED TECHNICIAN. THE LEVEL OF CERTIFICATION REQUIRED SHALL BE LEVEL II.
- THE CONTRACTOR SHALL BE RESPONSIBLE FOR DAMAGE TO ALL EXISTING UTILITIES. THE LOCATIONS OF UNDERGROUND UTILITIES AS SHOWN ON THE PLANS ARE APPROXIMATE ONLY. THE CONTRACTOR SHALL NOTIFY ALL UTILITY COMPANIES TO VERIFY IN THE FIELD THE LOCATIONS OF THEIR INSTALLATIONS 72 HOURS PRIOR TO CONSTRUCTION.

CALL-BEFORE-YOU-OVERHEAD 1-702-227-2929
 CALL-BEFORE-YOU-DIG 1-800-227-2600
 STREETLIGHTS 1-702-229-6331
 F.A.S.T. 1-702-432-5300

- ALL TRAFFIC SIGNAL INSTALLATIONS SHALL CONFORM TO THE UNIFORM STANDARD DRAWINGS SPECIFICATIONS AND SPECIAL PROVISIONS FOR PUBLIC WORKS' CONSTRUCTION OFF-SITE IMPROVEMENTS, CLARK COUNTY AREA, NEVADA, VOLUMES I AND II, ADOPTED BY THE REGIONAL TRANSPORTATION COMMISSION APRIL 8, 1992 WITH ALL SUBSEQUENT REVISIONS; BRACKET MOUNTED (SIDE-MOUNTED) VEHICLE SIGNAL ASSEMBLIES WITH 2 OR MORE SIGNAL HEADS SHALL HAVE AN ADDITIONAL ELBOW AS SHOWN IN UNIFORM STANDARD DRAWING NUMBER 863 AND SHOWN AS OPTION B IN UNIFORM STANDARD DRAWING NUMBER 844. AND SHALL HAVE A GENERAL LAC SUPPORT AS SHOWN IN UNIFORM STANDARD DRAWING NUMBER 863 IF ONE OF THE SIGNAL HEADS CONTAINS 4 OR MORE SIGNAL MODULES.

- SERVICE SHALL HAVE 1-60 AMP SINGLE POLE BREAKER FOR SIGNAL, AND ONE 40 AMP SINGLE POLE BREAKERS FOR STREET LIGHTS. SERVICE SHALL BE 200 AMP PADMOUNT AND SHALL HAVE A CAPACITY OF 20 OR 24 CIRCUITS.

- LINE SIDE OF METER TO BE WIRED WITH THREE #3/0 AWG THW. LOAD SIDE SHALL BE WIRED WITH FOUR #4 AWG THW (2 BLACK, 2 WHITE) AND ONE #8 AWG THW (GREEN).

- LUMINAIRES ON ALL SIGNAL POLES SHALL BE L.E.D. AS APPROVED BY THE CITY OF LAS VEGAS (CLV). DESIGN PROFESSIONAL AND CONTRACTOR SHALL VERIFY CITY'S LATEST LED FIXTURE SPECIFICATIONS AND APPROVED FIXTURES PER CLV WEBSITE. UNDER BUILDING AND SAFETY FORMS, PRIOR TO ORDERING MATERIALS. INTERSECTION LIGHTING SHALL MEET THE REQUIREMENTS OF UNIFORM STANDARD DRAWING NUMBER 300.S3. EACH LUMINAIRE SHALL HAVE AN INDIVIDUAL 1000 WATT P.E. CONTROL. FOR LUMINAIRES THERE SHALL BE 2(TWO)-#4 AWG THW CONDUCTORS FROM THE SERVICE TO THE CABINET. IN THE CABINET, THE #4 AWG THW CONDUCTORS SHALL BRANCH OFF TO #10 AWG THW CONDUCTORS INDIVIDUALLY FUSED WITH 10 AMP FUSES. THERE SHALL BE NO SPLICES BETWEEN THE CABINET AND LUMINAIRE FIXTURES.

- LUMINAIRES SHALL BE MARKED TO INDICATE INSTALLATION ORIENTATION, AND SHALL HAVE EXTERNAL LABELS PER ANSI C136.15 THAT INDICATE WATTAGE AND ARE CLEARLY VISIBLE FROM STREET LEVEL. TRAFFIC SIGNAL LUMINAIRES INSTALLED ADJACENT TO RESIDENTIAL HOUSING SHALL BE INSTALLED WITH MANUFACTURER PROVIDED HOUSE-SIDE SHIELDS.

- THE INTERNALLY ILLUMINATED STREET NAME SIGNS SHALL BE WIRED TO THE LUMINAIRE'S PHOTO CELL FOR CONTROL WITH #10 AWG THW COPPER STRANDED WIRE (TYPICAL). THE SIGNS SHALL BE WIRED TO THE LUMINAIRE DIRECTLY ABOVE IT. IN THE EVENT THERE IS NO LUMINAIRE ON THE TRAFFIC SIGNAL POLE, THE 1000 WATT P.E. CONTROL SHALL BE MOUNTED ON THE POLE CAP. ALL NEW ILLUMINATED STREET NAME SIGNS SHALL HAVE LIGHT EMITTING DIODE (LED) LAMPS PER SECTION 623 T.02.16 OF THE SPECIAL PROVISIONS.

- CHECK CONDUIT AND CABLE SCHEDULE FOR CONDUIT, CABLE, AND WIRE SIZE. VERIFY ALL EXISTING CONDUIT RUNS.

- ALL PULLBOXES SHALL BE IN ACCORDANCE WITH UNIFORM STANDARD DRAWINGS NO. 705, NO. 706, AND NO. 707.

- TRAFFIC SIGNAL CABLE SHALL BE 15 OR 25 CONDUCTOR #14 AWG SOLID (TYPICAL) CABLE AND SHALL CONFORM TO IMSA SPEC. NO. 20-1.

- PEDESTRIAN PUSH BUTTONS SHALL BE AUDIBLE TACTILE "POLARA NAVIGATOR" TYPE (2-WIRE PEDESTRIAN PUSHBUTTON SYSTEM WITH IN2 PUSH BUTTON STATIONS AND SHELF-MOUNT BIU CONTROL UNIT WITH SDLC CABLE) IN ACCORDANCE WITH CITY OF LAS VEGAS SPECIAL PROVISIONS AND SECTION 623 OF THE CCA USS. PUSH BUTTON SIGNS SHALL BE R10-36 PER MUTCD, 2009 EDITION, WITH FULL MOUNTING BRACKETS, AS MODIFIED BY THE MANUFACTURER TO FIT ON A 9"x12" SIGN, AND SHALL BE PORCELAIN-ENAMELED METAL. ALL PUSH BUTTONS TO BE MOUNTED 42" ABOVE SIDEWALK. THE MAXIMUM HORIZONTAL REACH DISTANCE IS TO BE 10". SIDEWALK RAMP WILL BE ACCORDING TO U.S.D. NO. 235 (1-4) LATEST EDITION. WHEN AN EXISTING SIGNAL WITH EXISTING AUDIBLE-TACTILE PUSH BUTTONS IS MODIFIED, THE CONTRACTOR SHALL VERIFY NEW PEDESTRIAN PUSH BUTTONS OR CABINET EQUIPMENT MATCHES THE MANUFACTURE AND MODEL OF ANY EXISTING EQUIPMENT SCHEDULED TO REMAIN, TO PROVIDE A FULLY FUNCTIONING SYSTEM. THE CONTRACTOR SHALL PROVIDE AND INSTALL ALL CABINET EQUIPMENT, INCLUDING THE PEDESTRIAN PUSH BUTTON CONTROL UNIT, INTERFACE PANEL AND ANY REQUIRED HARNESSSES, TO PROVIDE A FULLY FUNCTIONING SYSTEM.

- THE ROUTING AND TERMINATION OF CONDUITS AND THE PLACING OF POLES AND CABINETS SHALL BE AS INDICATED ON THE PLANS. ALL CHANGES SHALL BE APPROVED BY THE ENGINEER.

- MAST ARM R10-12 SIGNS TO BE ADJACENT (NO GAP) TO THE M-5 SIGNAL HEAD. WHERE FLASHING YELLOW ARROW LEFT TURN SIGNALS ARE USED, A MAST ARM R10-12" LEFT TURN YIELD ON FLASHING YELLOW ARROW SIGN SHALL BE MOUNTED ADJACENT TO THE M-4 SIGNAL HEAD.

- TRAFFIC SIGNAL CABINET SHALL BE A TYPE VIII CABINET UNLESS OTHERWISE SPECIFIED IN THE PLANS. THIS IS COMMONLY REFERRED TO AS AN "R" CABINET. THE CABINET SHALL CONFORM TO THE CLARK COUNTY AREA UNIFORM STANDARD DRAWINGS AND SPECIFICATIONS AND THE CITY OF LAS VEGAS SPECIAL PROVISIONS AND SHALL BE A NEMA TS2-TYPE2 CABINET. INSTALL CABINET NEAR THE R.O.W. LINE OR AS SHOWN ON THE DRAWINGS. THE TRAFFIC SIGNAL CONTROLLER CABINET SHALL BE EQUIPPED WITH 16 LOAD BAY POSITIONS AND SHALL BE A 64 DETECTOR CHANNEL R CABINET WITH RACK-MOUNTED DETECTION. THE CABINET SHALL CONTAIN A 764 OPTICOM PHASE SELECTOR, WITH A 768 AUXILIARY INTERFACE PANEL MOUNTED IN THE CABINET AND FULLY WIRED FOR GREEN SENSE CAPABILITIES. THE CABINET SHALL BE EITHER: MODEL R-44 CAB, TS2-2, LAS VEGAS, 64CH DET, PART # M73650 FROM MCCAIN, INC., MODEL MOBOTREX LAS VEGAS TS2-TYPE2 16 POS., 64 CH, DET, DRAWING # TF4216TV01 REV 3 FROM SIERRA TRANSPORTATION AND TECHNOLOGIES; OR MODEL TS2-2 HW 16 POSITION HORIZONTAL CITY OF LAS VEGAS CABINET, PART # 34413G12-02-06 FROM ECONOLITE CONTROL PRODUCTS, INC. ALL CABINETS SHALL BE PROVIDED WITH A COMPLETE SET OF FOUR BUS INTERFACE UNITS, POWER SUPPLY AND SDLC CABLES TO PROVIDE A FULLY FUNCTIONING SYSTEM. CABINET POWER SUPPLIES SHALL BE RENO A&E MODEL CPS-TS2-LED, PEEK MODEL PS101, OR ECONOLITE PS-200. BIUS SHALL BE RENO A&E MODEL 1240, PEEK MODEL BUS INTERFACE UNIT 82-1886-01, OR ECONOLITE PART # 160-1018-501.

- THE CONTRACTOR SHALL SUPPLY A MALFUNCTION MANAGEMENT UNIT (MMU) TO THE CITY OF LAS VEGAS TRAFFIC SIGNAL REPAIR SHOP A MINIMUM OF FOURTEEN DAYS PRIOR TO SIGNAL TURN-ON OR PRIOR TO CONVERTING TO A NEW PHASING SCHEME. FOR TESTING AND PROGRAMMING PURPOSES. THE MMU SHALL BE A MODEL MMU-1600GE AS MANUFACTURED BY RENO A&E, OR APPROVED EQUAL. THE CONTRACTOR SHALL DELIVER THE MMU TO AND PICKUP THE CONTROLLER AT 2965 RONEMUS DRIVE. CONTRACTOR SHALL NOTIFY TRAFFIC ENGINEERING FIELD OPERATIONS (702-229-6331) SEVEN DAYS PRIOR TO PICKUP. THE CITY, AT ITS DISCRETION, MAY PROVIDE A DIFFERENT MODEL MMU FOR INITIAL TURN-ON, IN WHICH CASE CITY PERSONNEL WILL SWAP THE MMU AFTER THE PROJECT IS ACCEPTED.

- CONTRACTOR SHALL POTHOLE SIGNAL POLE LOCATIONS PRIOR TO ORDERING OF POLES.

- ALL MAST ARMS TO BE HOT-DIP GALVANIZED BY THE MANUFACTURER THE MAST ARM IS TO BE FABRICATED WITH END TENON ONLY. THE END TENON SHALL BE FACTORY INSTALLED AND THE REMAINING TENONS SHALL BE FABRICATED IN THE FIELD AT THE LOCATION SHOWN ON THE PLANS OR AS DIRECTED BY THE TRAFFIC ENGINEER AND/OR HIS AUTHORIZED REPRESENTATIVE. FOR TENON FABRICATION DETAILS SEE CLARK COUNTY AREA U.S.D. NO. 808 SHEET 2. ALL WELDING SHALL CONFORM TO AWS D 2.0. "SPECIFICATION FOR WELDED HIGHWAYS AND RAILWAY BRIDGES," AND TO ANY ADDITIONAL REQUIREMENTS OF SECTION 623 OF THE SPECIFICATIONS. ALL EXPOSED WELDS, SHALL BE PAINTED AS PROVIDED FOR REPAIRING DAMAGED GALVANIZED SURFACES.

- ALL VEHICLE AND PEDESTRIAN SIGNAL INDICATIONS SHALL HAVE LIGHT EMITTING DIODE (LED) TYPE INDICATIONS, IN CONFORMANCE TO CITY OF LAS VEGAS SPECIAL PROVISIONS AND TO SECTION 623 OF THE CCA USS. ALL PEDESTRIAN SIGNAL FACES SHALL PROVIDE "WALKING PERSON", "HAND", AND "COUNTDOWN" MESSAGES AS PROVIDED BY DURALIGHT MODEL #JXM-400-VIEL OR DIALIGHT MODEL #430-6479-001X, OR APPROVED EQUAL. THE "COUNTDOWN" MESSAGE SHALL NOT FLASH. WHERE EXISTING SIGNALS ARE MODIFIED, THE CONTRACTOR SHALL VERIFY THAT LED PEDESTRIAN INDICATIONS FOR A SPECIFIC PHASE ARE OF THE SAME MANUFACTURE SO THAT THEY FUNCTION CORRECTLY, OR SHALL REPLACE ALL COUNTDOWN PEDESTRIAN INDICATIONS FOR THAT PHASE.

CLV TRAFFIC SIGNAL NOTES - CONTINUED

- VIDEO DETECTION SYSTEMS SHALL BE TS2 COMPATIBLE AND SHALL INPUT DETECTOR CALLS TO THE CONTROLLER THROUGH AN SDLC CABLE. SYSTEMS WILL BE EITHER ITERIS EDGE 2-IN PROCESSORS WITH VRACKS-PS, EDGE2-TS2-IM-PAK AND EDGECONNECT PAK, (IP ADDRESSABLE); PEEK VIDEOTRAK IQ (WITH ETHERNET PORT AND SDLC); ECONOLITE AUTOSCOPE VISION SYSTEM WITH COMM MANAGER AND MINI DETECTION PROGRAMMING KIT MOUNTED IN THE CABINET. WHEN VIDEO DETECTION IS SPECIFIED ON THE TRAFFIC SIGNAL PLANS. ALL VIDEO DETECTION SYSTEMS WILL BE STAND ALONE SYSTEMS TO INCLUDE ALL NECESSARY EQUIPMENT TO PROGRAM THE VIDEO DETECTION SYSTEM. A PROGRAMMING "MOUSE", KEYPAD OR LAPTOP COMPUTER (IF REQUIRED FOR PROGRAMMING THE VIDEO DETECTION SYSTEM) AND APPROPRIATE SOFTWARE WILL BE SUPPLIED WITH EACH VIDEO SYSTEM. PERSONAL COMPUTERS (PCs) MAY NOT BE SUBSTITUTED FOR LAPTOPS. A VIDEO MONITOR (COLOR FLAT SCREEN) 9" TO 13" WILL BE SUPPLIED WITH EACH VIDEO DETECTION SYSTEM. EACH VIDEO CAMERA WILL HAVE POWER AND VIDEO CABLE DIRECTLY FROM THE CABINET. COAXIAL CABLE WILL BE TYPE 8281 (SOLID CENTER CONDUCTOR). CAMERAS THAT USE A PREFABRICATED CABLE INTEGRATING POWER AND VIDEO INTO A SINGLE WEATHERPROOF CONNECTOR ARE ACCEPTABLE. "BNC" ARE THE ONLY ACCEPTABLE TERMINATION OF COAXIAL CABLES. CAMERAS WILL BE MOUNTED PER MANUFACTURER'S RECOMMENDATIONS AND PER CLV TRAFFIC ENGINEER APPROVAL. VIDEO CAMERAS SHALL BE COLOR AND SHALL BE MOUNTED ON A MINIMUM 6 FOOT RISER ON THE SIGNAL MAST ARM WITH EXTENSION BRACKETS (TYPE AG-0175-74-62 OR EQUIVALENT). THE LOCATION OF THE CAMERA ON THE MAST ARM SHALL BE APPROVED BY THE TEFO TRAFFIC SIGNAL SUPERVISOR. A VIDEO FILTER (CX06-BNYC OR EQUIVALENT) WILL BE INSTALLED IN THE SIGNAL CABINET FOR EACH CAMERA VIDEO INPUT WHEN COAX IS USED. VIDEO DETECTION PROCESSORS AND COMMUNICATIONS CARDS SHALL BE PROVIDED WITH THE LATEST VERSIONS OF THE MANUFACTURER'S SOFTWARE. THE CONTRACTOR SHALL AIM CAMERAS AND PROGRAM AND CONFIGURE THE VIDEO DETECTION PROCESSORS TO PROVIDE A FULLY FUNCTIONING SYSTEM.

- WHERE NEW LOOPS WILL BE OVERLAID WITH NEW PAVEMENT, LOOP DETECTORS SHALL BE PREFORMED LOOPS AS MANUFACTURED BY RENO A & E LOOP SYSTEMS AND ALL LOOPS SHALL BE INSTALLED IN THE ROADWAY PRIOR TO PLACEMENT OF THE FINAL PAVEMENT LIFT. WHERE NEW LOOPS ARE INSTALLED THAT ARE NOT OVERLAID WITH NEW PAVEMENT, LOOPS SHALL BE CABLE-IN-DUCT PER SECTION 623 T.02.04 C OF THE CITY OF LAS VEGAS SPECIAL PROVISIONS. LOOP LEAD-IN CABLE SHALL BE 6-PAIR 18 AWG MULTIPLE CONDUCTOR CABLE AS SPECIFIED IN SECTION 623 T.02.04 OF THE CLV SPECIAL PROVISIONS. ALL WIRING HARNESSSES, RACK POSITIONS, AND LOOP LEAD-IN CABLE SHALL BE CLEARLY MARKED AS TO THE APPROPRIATE PHASE AND LETTER DESIGNATION TO WHICH IT BELONGS AS SHOWN ON THE TRAFFIC SIGNAL PLANS. LOOPS SHALL BE LOCATED AS SHOWN ON THE TRAFFIC SIGNAL PLANS AND APPROVED BY THE CLV TRAFFIC ENGINEERING DIVISION PRIOR TO INSTALLATION. REFER TO SECTION 623 T.02.04 OF THE CLV SPECIAL PROVISIONS FOR ADDITIONAL REQUIREMENTS.

- OPTICAL PREEMPTION UNITS WILL BE GLOBAL TRAFFIC TECHNOLOGIES (ENCODING CAPABLE), MODEL 764 OPTICOM PHASE SELECTOR INSTALLED IN THE MODEL 760 RACK WITH A MODEL 768 AUXILIARY INTERFACE PANEL (AIP) MOUNTED IN THE CABINET AND FULLY WIRED FOR GREEN SENSE CAPABILITIES. OPTICAL SENSORS WILL BE MODEL 721 WITH ONE DETECTOR PER DIRECTION, UNLESS SHOWN OTHERWISE IN THE PLANS, AND WILL BE INTERFACED TO THE TRAFFIC SIGNAL CONTROLLER CABINET WITH M-138 CABLE. THE SOUTHBOUND OPTICOM DETECTOR SHALL BE WIRED TO INPUT PREEMPTS ON CHANNEL 1 IN THE PHASE SELECTOR, EASTBOUND ON CHANNEL 2, NORTHBOUND ON CHANNEL 3, AND WESTBOUND ON CHANNEL 4. UNLESS VARIATIONS ARE APPROVED BY THE TRAFFIC SIGNAL SUPERVISOR. WHEN 764 PHASE SELECTORS ARE ADDED TO A CABINET WITHOUT A 768 AIP, THE CONTRACTOR SHALL INSTALL AND WIRE A NEW 768 AIP.

- IF THE IMPROVEMENTS NECESSITATE THE OBLITERATION, TEMPORARY CONSTRUCTION, TEMPORARY REMOVAL, OR RELOCATION OF ANY EXISTING TRAFFIC PAVEMENT MARKING, SUCH PAVEMENT MARKING SHALL BE RESTORED OR REPLACED AT THE CONTRACTORS EXPENSE TO THE SATISFACTION OF THE CITY.

- INTERCONNECT CABLE SHALL BE AS SHOWN IN THE WIRE SCHEDULE.

- THE CONTRACTOR SHALL INSTALL CROSSWALKS, STOP BARS, STRIPING AND SIGNS AS IDENTIFIED ON THE PLANS.

- WHERE THE PLANS CALL FOR REMOVAL AND SALVAGE OF EXISTING TRAFFIC SIGNAL EQUIPMENT, THE CONTRACTOR SHALL CALL 702-229-6331 TO SPEAK TO A TRAFFIC FIELD SUPERVISOR TO ARRANGE FOR DELIVERY TIMES AND LOCATIONS.

- THE CONTRACTOR SHALL MAINTAIN EXISTING SIGNALS THROUGH THE LIFE OF THE PROJECT PER SECTION 623 G.03.01N OF THE CLV SPECIAL PROVISIONS.

REVISED DECEMBER 1, 2021

SOUTHERN NEVADA - SOUTHWEST GAS CORPORATION GENERAL NOTES

- IN THE EVENT OF NATURAL GAS EMERGENCIES CALL 911 AND 1-877-860-6020
- MINIMAL HORIZONTAL AND VERTICAL CLEARANCES BETWEEN NATURAL GAS FACILITIES AND ANY UNDERGROUND UTILITIES AND/OR STRUCTURES, INCLUDING BUT NOT LIMITED TO WATER, SEWER, STORM DRAIN, COMMUNICATIONS, AND ELECTRIC SHALL BE AT LEAST 12-INCHES OR GREATER AS DICTATED BY LOCAL CODES AND STANDARDS.
 - ANY DEVIATION FROM SPECIFIED MINIMUM CLEARANCES MUST BE APPROVED BY ALL AFFECTED UTILITIES AND/OR MUNICIPALITIES
- FOR VALVE ADJUSTMENT CONTACT 702-528-7855 14 DAYS PRIOR TO CONSTRUCTION
- IN THE EVENT OF A NATURAL GAS CONFLICT WITH PROPOSED UTILITIES AND/OR STRUCTURES CONTACT 702-365-2099
- FOR STANDBY WHEN EXCAVATING (INCLUDING SAW CUTTING AND PAVEMENT REMOVAL) OVER OR NEAR HIGH PRESSURE GAS LINES CONTACT 702-278-8451 48 HOURS PRIOR TO CONSTRUCTION.

ALL CIVIL IMPROVEMENT PLANS MUST INCLUDE SOUTHWEST GAS CORPORATION HIGH PRESSURE NOTES ON THE NOTES SHEET AND ALL SHEETS DEPICTING HIGH PRESSURE NATURAL GAS MAINS AS INDICATED BELOW:

CAUTION: HIGH PRESSURE GAS!!

CALL SOUTHWEST GAS AT 702-278-8451 FOR STANDBY WHEN EXCAVATING (INCLUDING SAW CUTTING AND PAVEMENT REMOVAL) OVER OR NEAR HIGH PRESSURE GAS LINES 48 HOURS PRIOR TO CONSTRUCTION

APPROVED FOR CONSTRUCTION	
SOUTHWEST GAS CORPORATION	DATE

ALIGNMENT ABBREVIATIONS

- X X STREET NAME ALIGNMENT
- Y Y STREET NAME ALIGNMENT

LEGEND

---	CONTOUR - MAJOR		ASPHALT (REMOVAL)
---	CONTOUR - MINOR		ASPHALT (NEW)
---	CENTERLINE		CONCRETE (REMOVAL)
---	PROFILE GRADE LINE		CONCRETE (NEW)
---	EDGE OF PAVEMENT		MEDIAN (REMOVAL)
---	FLOWLINE		MEDIAN (NEW)
---	BACK OF CURB		LANDSCAPING (NEW)
---	SIDEWALK		ADA RAMP (NEW)
---	RIGHT OF WAY LINE		EXISTING BUILDING
---	PROPERTY LINE		AUTHORIZATION TO ENTER PROPERTY (AEP)
---	PATCH / SAWCUT LINE		
---	GRADE BREAK		
---	CONDUIT - FIBER (NEW)		
---	CONDUIT - FIBER (EX)		
---	CONDUIT - PHONE (NEW)		
---	CONDUIT - PHONE (EX)		
---	CONDUIT - POWER (NEW)		
---	CONDUIT - POWER (EX)		
---	CONDUIT - SGLT (NEW)		
---	CONDUIT - SGLT (EX)		
---	CONDUIT - CATV (NEW)		
---	CONDUIT - CATV (EX)		
---	CONDUIT - TSIG (NEW)		
---	CONDUIT - TSIG (EX)		
---	PIPE - IRRIGATION (NEW) SMALLER THAN 12"		
---	PIPE - IRRIGATION (EX) SMALLER THAN 12"		
---	PIPE - NATURAL GAS (NEW) SMALLER THAN 12"		
---	PIPE - NATURAL GAS (EX) SMALLER THAN 12"		
---	PIPE - NATURAL GAS (NEW) 12" AND LARGER		
---	PIPE - NATURAL GAS (EX) 12" AND LARGER		
---	PIPE - SANITARY SEWER (NEW) SMALLER THAN 12"		
---	PIPE - SANITARY SEWER (EX) SMALLER THAN 12"		
---	PIPE - SANITARY SEWER (NEW) 12" AND LARGER		
---	PIPE - SANITARY SEWER (EX) 12" AND LARGER		
---	PIPE - STORM (NEW) SMALLER THAN 12"		
---	PIPE - STORM (EX) SMALLER THAN 12"		
---	PIPE - STORM (NEW) 12" AND LARGER		
---	PIPE - STORM (EX) 12" AND LARGER		
---	PIPE - WATER (EX) SMALLER THAN 12"		
---	PIPE - WATER (NEW) 12" AND LARGER		
---	PIPE - WATER (EX) 12" AND LARGER		

RTC TRANSIT NOTES

- THE CONTRACTOR SHALL NOT BE ALLOWED TO CLOSE MORE THAN ONE CONSECUTIVE BUS STOP ON THE SAME SIDE OF THE STREET. TEMPORARY BUS STOPS AND BUS STOP AMENITIES SHALL BE AMERICANS WITH DISABILITIES ACT (ADA) COMPLIANT AT ALL TIMES. THE CONTRACTOR SHALL NOTIFY RTC TRANSIT OF PROPOSED BUS STOP CLOSURES AND/OR BUS STOP AMENITY DISRUPTIONS VIA NOTIFYRTCTRANSIT@RTCSNV.COM AT LEAST SEVEN CALENDAR DAYS PRIOR TO THE START OF WORK. NOTIFICATION OF BUS STOP CLOSURES INVOLVING REMOVAL OF EXISTING AMENITIES SHALL BE PROVIDED TO RTC TRANSIT AT LEAST 10 CALENDAR DAYS PRIOR TO THE START OF WORK.
- THE CONTRACTOR SHALL SUBMIT A BUS STOP CLOSURE SCHEDULE TO RTC TRANSIT WITH THE APPROVED TRAFFIC CONTROL PLAN AT LEAST SEVEN CALENDAR DAYS PRIOR TO THE START OF WORK. THE BUS STOP CLOSURE SCHEDULE SHALL IDENTIFY THE DURATION OF PROPOSED BUS STOP CLOSURES AND TEMPORARY BUS STOP RELOCATIONS AND TIMES OF DAY THAT STOPS ARE EXPECTED TO BE IMPACTED BY THE WORK. ALL BUS STOP CLOSURES, TEMPORARY BUS STOPS, AND TEMPORARY BUS TURN OUTS MUST BE APPROVED BY RTC TRANSIT STAFF PRIOR TO THE START OF WORK.

REVISED JANUARY 24, 2019

RTC FAST NOTES

- CONTRACTOR IS TO MAINTAIN AND KEEP OPERATIONAL ALL EXISTING ITS INFRASTRUCTURE WITHIN THE CONSTRUCTION LIMITS. IF ANY EXISTING ITS INFRASTRUCTURE IS DAMAGED DUE TO CONSTRUCTION, WITHIN THE PROJECT LIMITS, THE CONTRACTOR SHALL IMMEDIATELY CONTACT MR. LONNIE BROWN (RTC/FAST MANAGER TRAFFIC SYSTEMS MAINTENANCE) AT 702-290-1979 CELL OR 702-432-5300 GENERAL.
- IF ANY FIBER OPTIC CABLE IS TO BE CUT, SPLICED AND OR PULLED, ALONG OR ADJACENT TO THE PROJECT LIMITS, THE CONTRACTOR IS TO CONTACT MR. LONNIE BROWN TWO (2) WEEKS IN ADVANCE FOR SYSTEM SHUTDOWN COORDINATION.
- CONTRACTOR MUST NOTIFY MR. LONNIE BROWN AT 702-290-1979 CELL, 702-432-5300 GENERAL, OR AT BrownL@rtcsnv.com, ONCE ALL PROJECT ITS FIBER OPTIC WORK IS COMPLETE. A COPY OF AS-BUILT DRAWINGS MUST BE PROVIDED TO RTC/FAST UPON COMPLETION OF PROJECT.

REVISED MAY 1, 2020

SYMBOLS

	ANTENNA / TOWER		SHRUB
	AREA LIGHT		SIDEWALK RAMP
	BENCHMARK		SIGN
	BLOW OFF		STREET LIGHT
	BUS SHELTER		STORM DRAIN INLET
	CABINET		SURVEY MONUMENT
	FIRE HYDRANT		TRAFFIC PED. SIGNAL
	HC PARKING SYMBOL		TRAFFIC SIGNAL POLE
	IRR. CONTROLLER		TREE
	LOOP DETECTOR		UTILITY POLE
	MANHOLE		UTILITY POLE GUY WIRE
	METER (BOX)		VALVE
	METER (PEDISTAL)		VAULT
	PALM TREE		WHEEL STOP
	PULLBOX		

ABBREVIATIONS

@	ABANDONED	L	LENGTH LINEAL FOOT, LINEAR FEET
ABAN	ASPHALTIC CONCRETE	LF	LEFT
AC	ASBESTOS CEMENT PIPE	LT	LAS VEGAS VALLEY WATER DISTRICT
ACP	AUTHORIZATION TO ENTER PROPERTY	LWVD	MANHOLE
AEP	ARTERIAL MANAGEMENT SYSTEM	MH	MULTI-LAYER COMPOSITE PIPE
AMS	APPROXIMATE	MCLCP	METER
APPROX	AIR VALVE ASSEMBLY	MTR	NEVADA DEPT OF TRANSPORTATION
AVAR	BACK OF CURB	NDOT	NOT TO SCALE
B/C	BEGIN OF CURB RETURN (AT B/C)	NTS	NV ENERGY
BCR	BENCHMARK	NVE	OVERHEAD POWER LINE
BM	BOTTOM	OHP	OVERHEAD UTILITIES
BOT	BACK OF RAMP	OBU	PULL BOX
BR	BACK FLOW PREVENTER	PB	POINT OF CURVATURE
B/C	C & G	PC	PROTECT IN PLACE
CALC'D	CALCULATED	P.C.P.	POINT ON CURVE
CATV	CABLE TELEVISION	POC	POWER POLE
CATV, TV	CLARK COUNTY	PP	POINT OF REVERSE CURVE
CC	CLARK COUNTY PUBLIC WORKS	PRC	POINT OF TANGENCY
CCPW	CURED-IN-PLACE PIPE	PT	PROPERTY LINE
CIPP	CENTERLINE	PL	RADIUS
.CL	CONTROLLED LOW STRENGTH MATERIAL	R	RIGHT
CLSM	CITY OF LAS VEGAS	RT	RIGHT OF WAY
CLV	CORRUGATED METAL PIPE	R/W	STEEL CYLINDER CONCRETE
CMP	CONCRETE	SCCP	PIPE
CONC	CONDUCTOR	SD, STRM	STORM DRAIN
COND	CAPITAL PROJECT	SF	SQUARE FOOT
CPM	MANAGEMENT	SP	SPECIAL PROVISIONS
D, DIA	DIAMETER	SS, SSSW	SANITARY SEWER
D, DCSWCS	DESIGN & CONSTRUCTION STDS FOR WASTEWATER COLLECTION SYSTEMS	STA	STATION
DG	DECOMPOSED GRANITE	STD	STANDARD
DI	DROP INLET	SLGT, SL	STREET LIGHT
DIP	DUCTILE IRON PIPE	SV	SPRINKLER VALVE
DW, DWY	DRIVEWAY	S/W	SIDEWALK
DWG	DRAWING	SWG	SOUTHWEST GAS
ECR	END OF CURB RETURN (AT B/C)	SY	SQUARE YARD
ELEC, E	ELECTRIC	T, TELE	TELEPHONE
ELEV	ELEVATION	TC	TOP OF CURB
EOP, EP	EDGE OF PAVEMENT	TCE	TEMP. CONSTRUCTION
EX	EXISTING	TEMP.	EASEMENT
FAST	FREEWAY & ARTERIAL SYSTEM OF TRANSPORTATION (INTERCONNECT)	TRANS.	TEMPORARY TRANSITION
FC	FACE OF CURB	TRC	TOP OF RAMP CURB
FD	FOUND	TSIG	TRAFFIC SIGNAL
FG	FINISHED GRADE	TYP.	TYPICAL
FH, HYD	FIRE HYDRANT	UDACS	UNIFORM DESIGN & CONSTRUCTION
FT, FEET	FOOT, FEET	USD	UNIFORM STANDARD DRAWING
G, GNAS	GAS METER	USS	UNIFORM STD SPECIFICATIONS
GM	GAS VALVE	V	VERTICAL SCALE
GV	GUY WIRE	W, WTR, WATR	WATER
GW	HIGH PRESSURE	WC	WHEEL CHAIR
HP	HORIZONTAL SCALE	WM	WATER METER
INT	INTERSECTION	WW	WATER VALVE
IRR	IRRIGATION	W/	WITH
			INCLUDED DELTA ANGLE

CALL BEFORE CONSTRUCTION

BEFORE YOU DIG	USA NORTH	811 OR 800-227-2600
BEFORE YOU UNDERGROUND	CLARK COUNTY TRAFFIC OPERATIONS	702-455-75

SHEET INDEX

No.	SHEET	TITLE
1	CV	COVER SHEET
2	G-01	GENERAL NOTES
3	G-02	GENERAL NOTES
4	G-03	SHEET INDEX
5	C-01	DEMOLITION PLAN
6	C-02	PROPOSED IMPROVEMENTS
7	C-03	UTILITY PLAN
8	C-04	STORM DRAIN PLAN AND PROFILE

VICINITY MAP

NOT TO SCALE

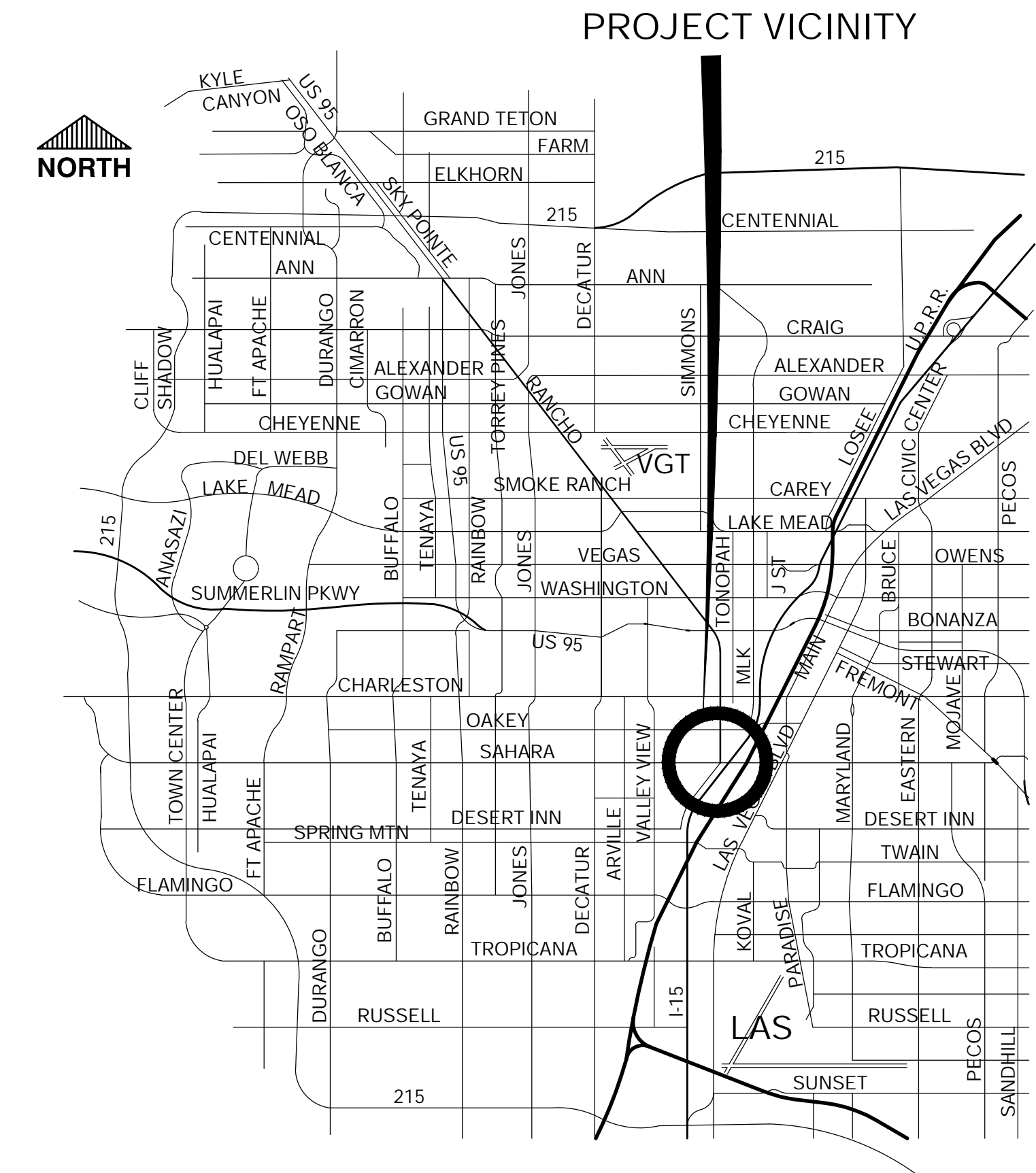

NO.	DATE	SHEET	REVISIONS

PREPARED BY

latitude 33
 PLANNING & ENGINEERING
 10731 Travena Street, San Diego, CA 92131
 Tel: 602.511.6633

LATITUDE 33
 PLANNING AND ENGINEERING

NOT FOR CONSTRUCTION

PREPARED FOR	CITY OF LAS VEGAS		
BID #	BSL3 LAB	DATE:	5/10/2024
MWA #	#####	DESIGNED BY:	KC
SUBMITTAL STAGE:	50% DD	DRAWN BY:	KC
CHECKED BY:	VB		
TITLE	SNHD BSL3 LAB		
SHEET	GENERAL NOTES		
SHEET	G-03		
DRAWING NO.	4 8		
	###		

5/02/24 H:\19300\19300 - EWING COLE - SNHD BSL3 LAB VEGAS ENGINEERING\LANDPUBLIC IMPROVEMENT PLANS\01 SNHD LAB PUBLIC IMP - DEMO PLAN.DWG

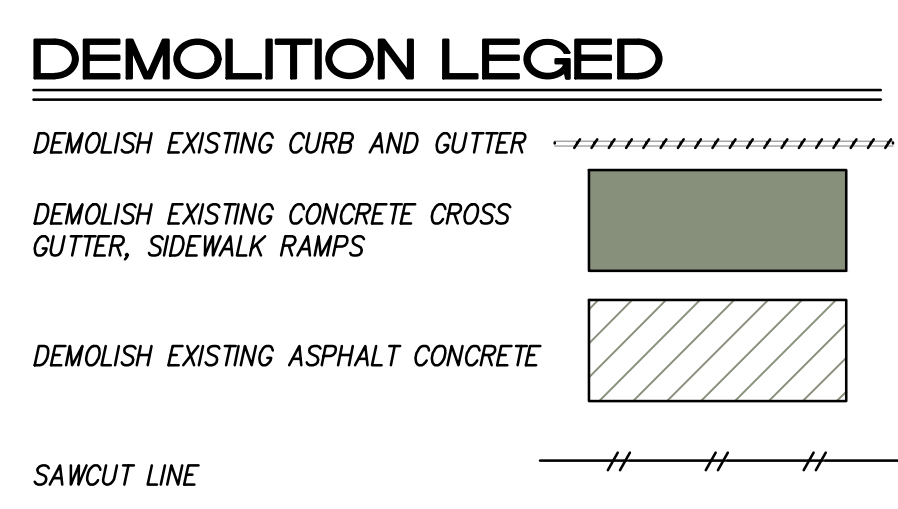
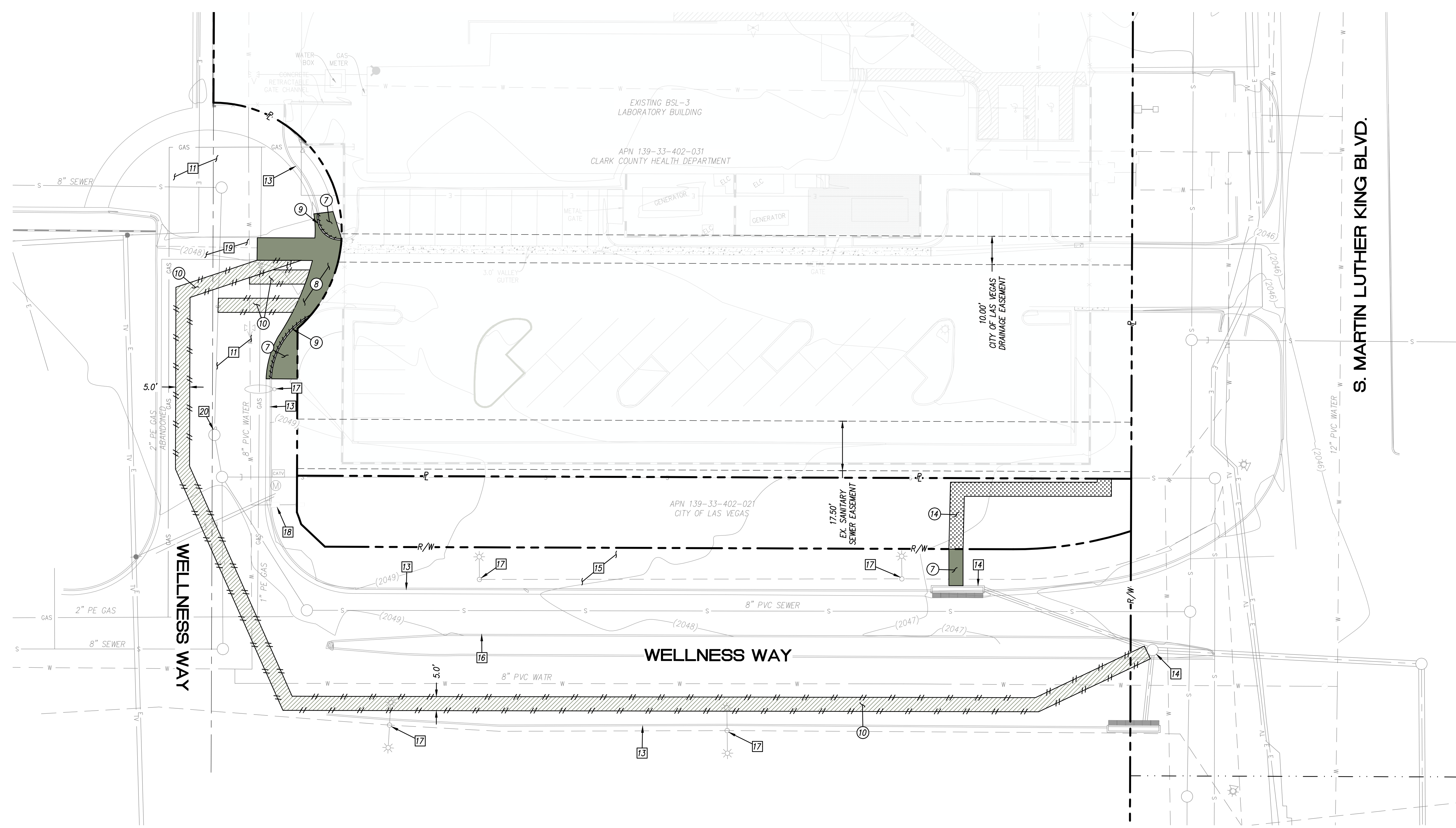

- DEMOLITION NOTES**
- ⑦ DEMOLISH EXISTING PEDESTRIAN RAMP.
 - ⑧ DEMOLISH EXISTING CROSS GUTTER.
 - ⑨ DEMOLISH EXISTING CURB AND GUTTER.
 - ⑩ TRENCH EXISTING ASPHALT CONCRETE FOR PROPOSED UTILITY.
 - ⑭ CLEAR AND GRUB EXISTING LANDSCAPE.

- PROTECT IN PLACE NOTES**
- ⑪ PROTECT IN PLACE EXISTING AC PAVING.
 - ⑬ PROTECT IN PLACE EXISTING CURB AND GUTTER.
 - ⑭ PROTECT IN PLACE EXISTING STORM DRAIN STRUCTURE.
 - ⑮ PROTECT IN PLACE EXISTING SIDEWALK
 - ⑰ PROTECT IN PLACE EXISTING LIGHT POLE.
 - ⑱ PROTECT IN PLACE EXISTING IRRIGATION METER.
 - ⑲ PROTECT IN PLACE EXISTING CROSS GUTTER.
 - ⑳ PROTECT IN PLACE EXISTING SEWER STRUCTURE.

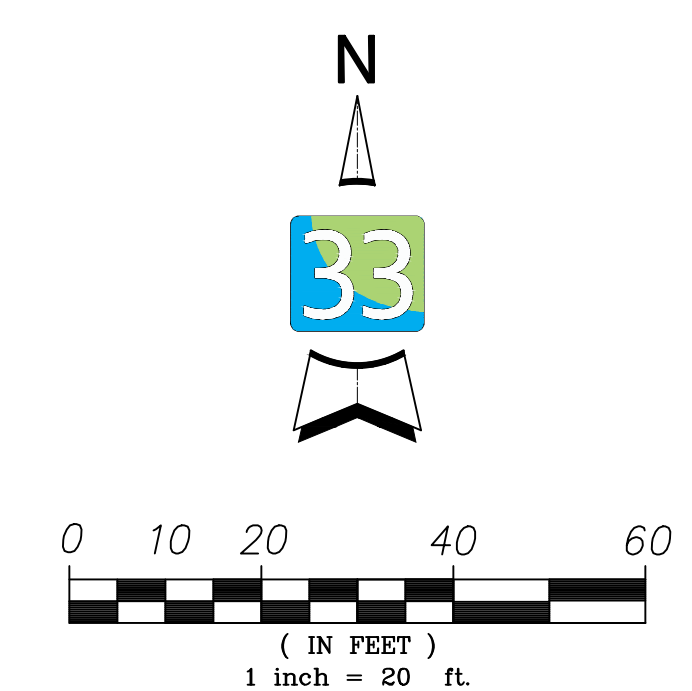

PREPARED BY	latitude 33 PLANNING & ENGINEERING 10731 Trenna Street, San Diego, CA 92131 Tel: 602.51.6633		LATTITUDE 33 PLANNING AND ENGINEERING	REVISIONS
NOT FOR CONSTRUCTION				
PREPARED FOR	TITLE	SHEET	NO.	DATE
CITY OF LAS VEGAS	SNHD BSL3 LAB	DEMOLITION PLAN		
BID # BSL3 LAB	DATE: 5/10/2024	DESIGNED BY: KC		
MWA # #####		DRAWN BY: KC		
SUBMITTAL STAGE:	50% DD	CHECKED BY: VB		
C-01				
5	8			
DRAWING NO. #####				

H:\1900\190300 - EWING COLE - SNHD BSL3 LAB VEGAS\ENGINEERING\LAND\PUBLIC IMPROVEMENT\PLANS\CITY OF SNHD LAB\PUBLIC IMP - IMP PLAN.DWG
5/10/24

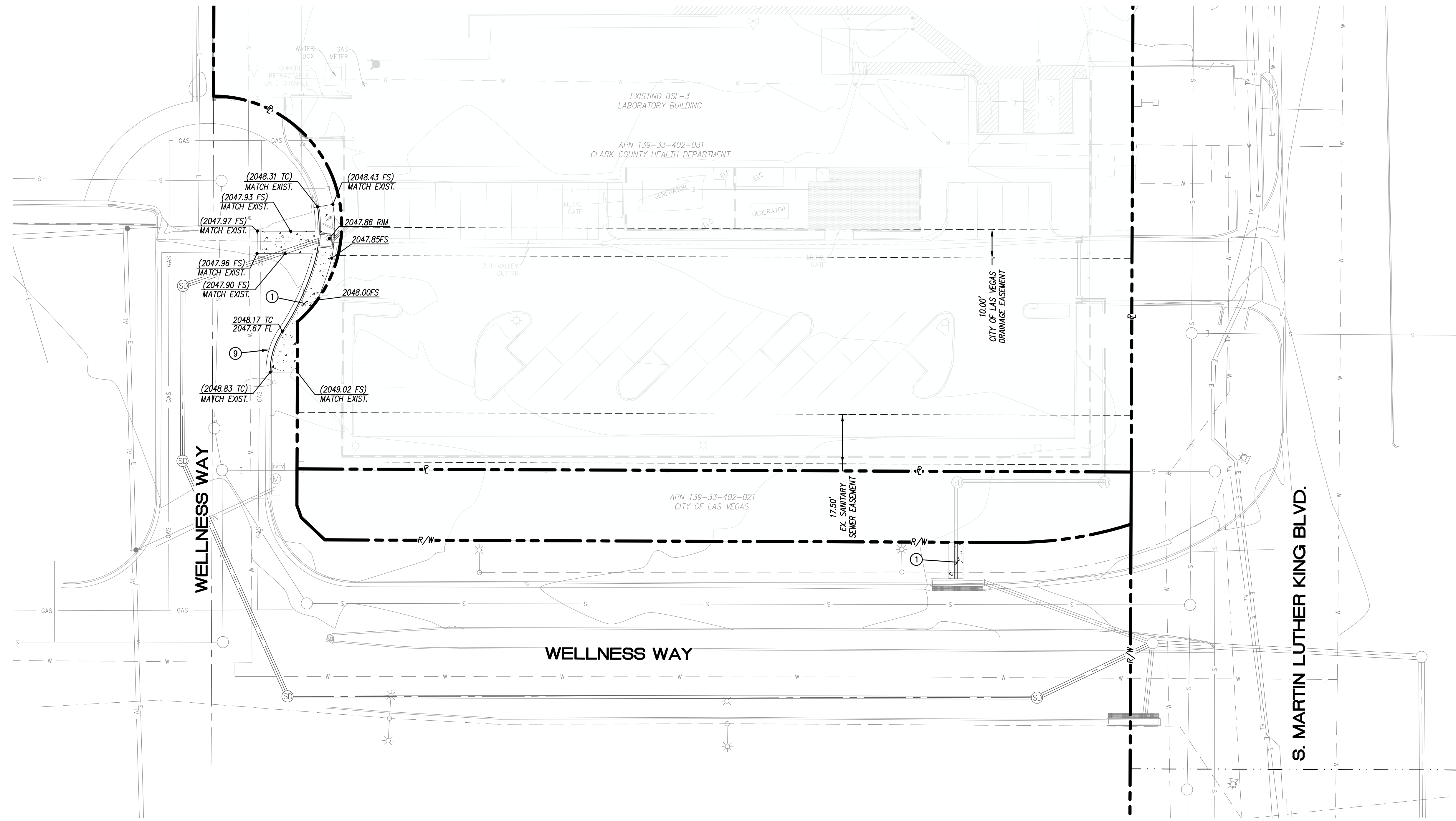

IMPROVEMENTS LEGED



CONSTRUCTION NOTES

- ① PROPOSED PCC SIDEWALK.
- ⑨ PROPOSED 6" CURB AND GUTTER.

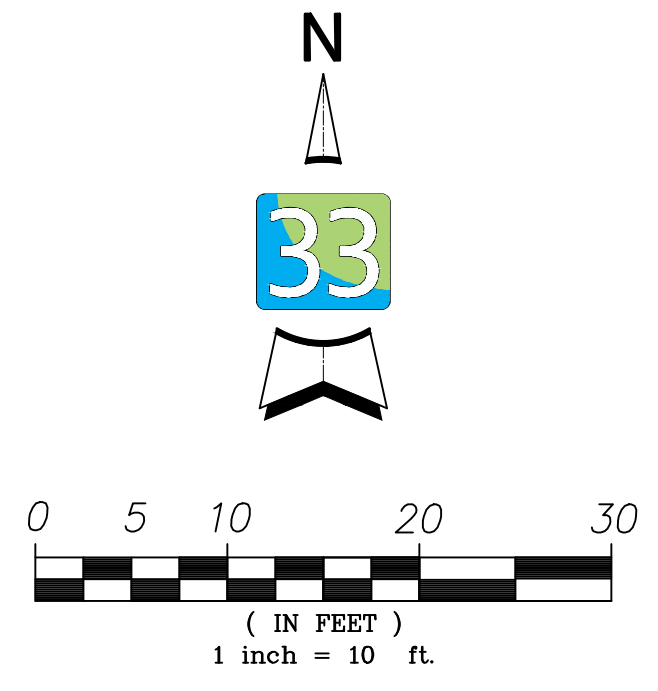

PREPARED FOR CITY OF LAS VEGAS	TITLE SNHD BSL3 LAB		
	BID # BSL3 LAB	DATE: 5/10/2024	SHEET C-02
MWA # #####	DESIGNED BY: KC	DRAWN BY: KC	CHECKED BY: VB
SUBMITTAL STAGE: 50% DD	SHEET NO. 6 OF 8		
DRAWING NO. #####	PREPARED BY latitude 33 PLANNING & ENGINEERING 10731 Trivona Street, San Diego, CA 92131 Tel: 602.591.6033		
NOT FOR CONSTRUCTION		LATTITUDE 33 PLANNING AND ENGINEERING	
REVISIONS		NO.	DATE
SHEET		NO.	DATE

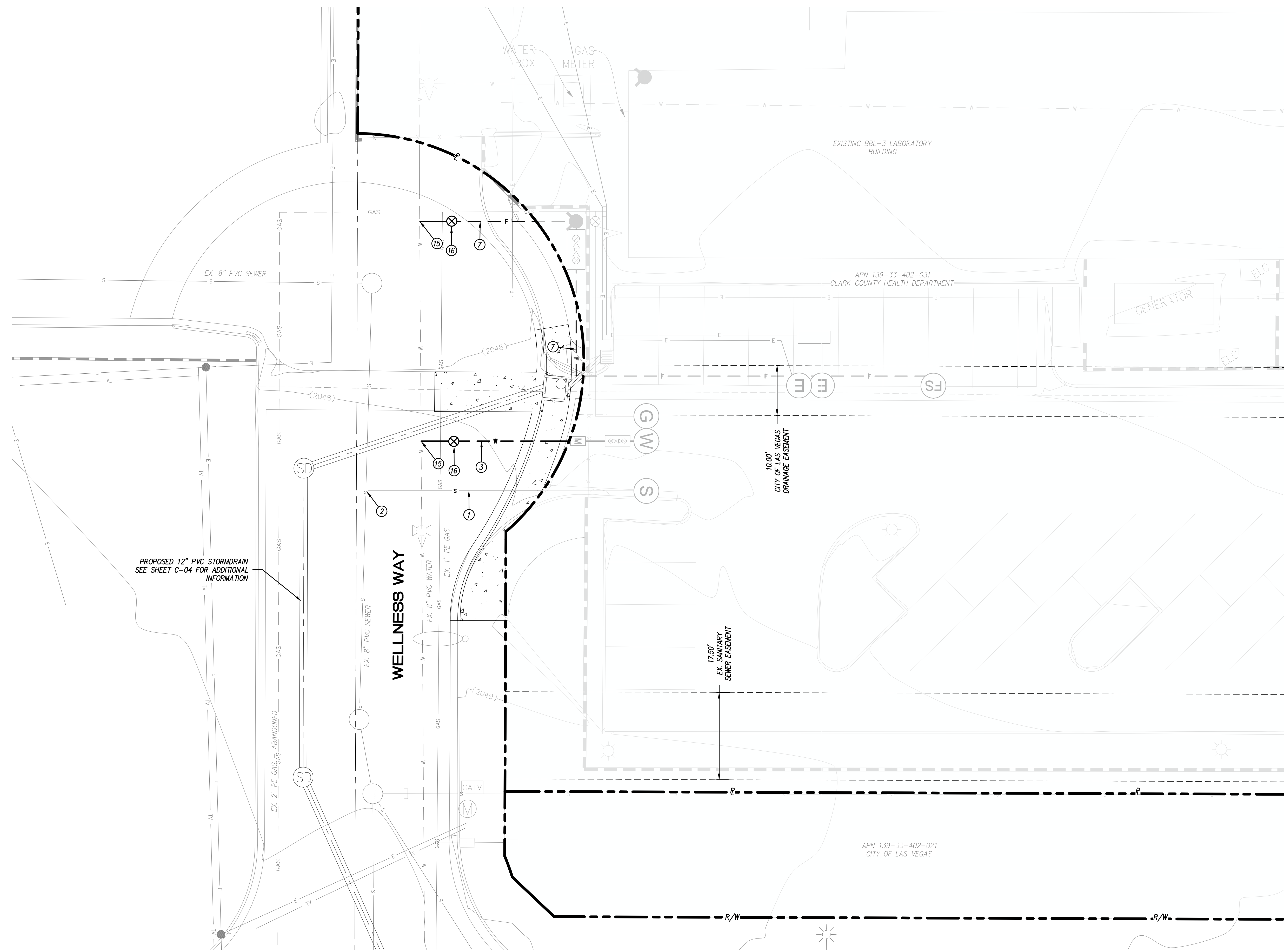

CONSTRUCTION NOTES

- ① PROPOSED 4" PVC SEWER.
- ② CONNECT TO EXISTING SEWER MAIN.
- ③ PROPOSED 3" WATER SERVICE.
- ⑦ PROPOSED 8" PVC FIRE SERVICE.
- ⑮ CONNECT TO EXISTING WATER.
- ⑯ PROPOSED GATE VALVE.

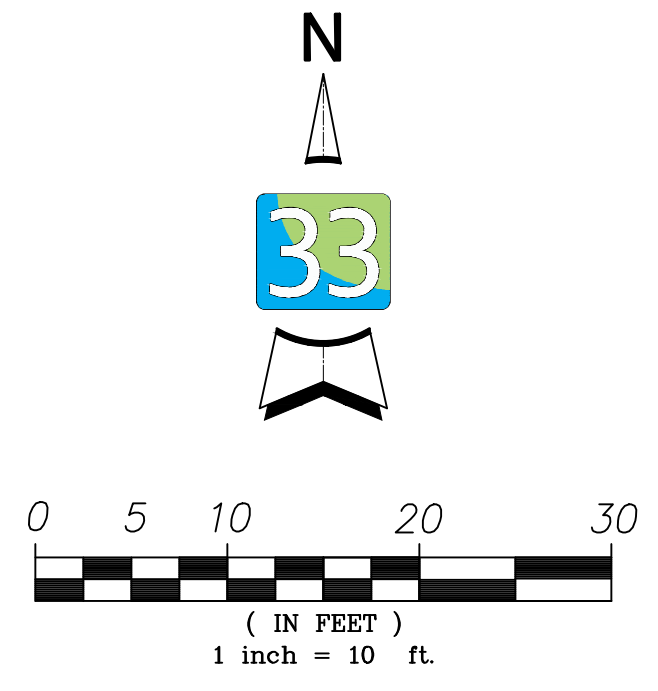

PREPARED BY latitude 33 PLANNING & ENGINEERING 10731 Travena Street, San Diego, CA 92131 Tel: 602-517-6033		LATTITUDE 33 PLANNING AND ENGINEERING	
PREPARED FOR CITY OF LAS VEGAS		TITLE SNHD BSL3 LAB	
BID # BSL3 LAB DATE: 5/10/2024		SHEET UTILITY PLAN	
MWA # ##### DESIGNED BY: KC		SUBMITTAL STAGE: 50% DD	
DRAWN BY: KC		CHECKED BY: VB	
SHEET C-03		DRAWING NO. ###	
NO. DATE SHEET		REVISIONS	

NOT FOR CONSTRUCTION

CONSTRUCTION NOTES

- ⑥ PROPOSED 48" TYPE 1 SD MH.
- ⑭ PROPOSED TYPE "C-D" MODIFIED DROP CURB INLET.

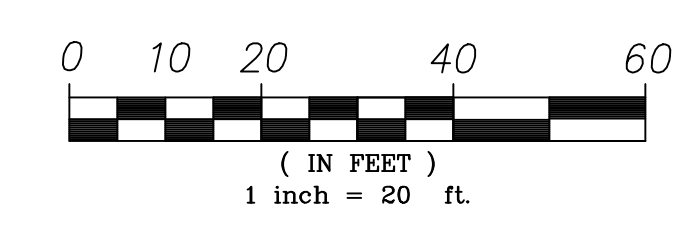
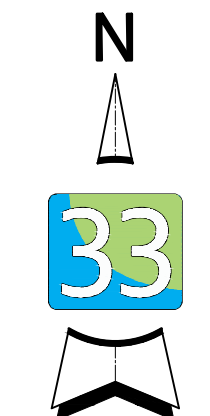
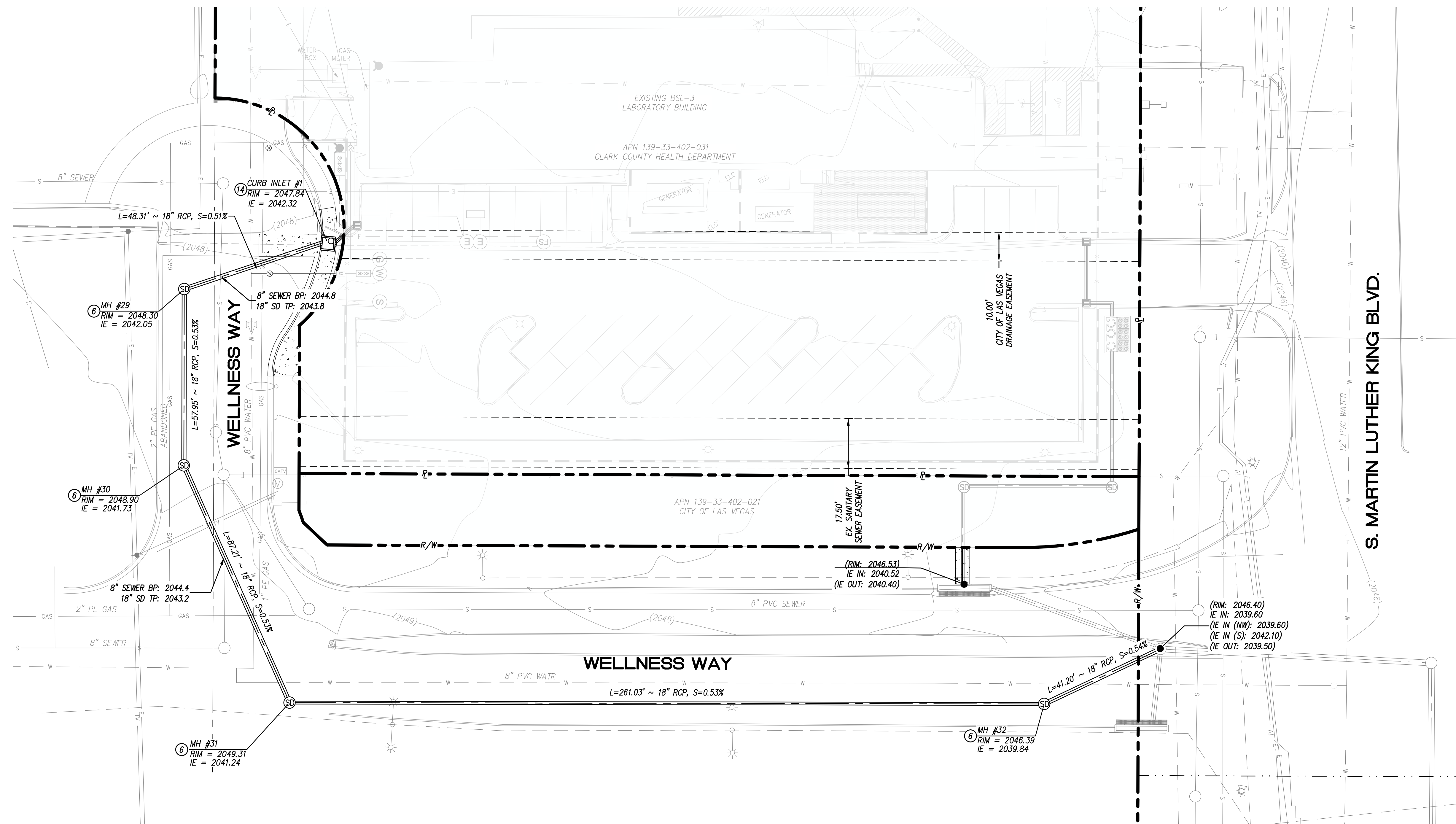

NO.	DATE	SHEET	REVISIONS

PREPARED BY
latitude 33
 PLANNING & ENGINEERING
 10731 Travena Street, San Diego, CA 92131
 Tel: 602.511.6633
 LATITUDE 33
 PLANNING AND ENGINEERING

NOT FOR CONSTRUCTION

TITLE
**SNHD
 BSL3 LAB
 STORM DRAIN PLAN AND
 PROFILE**

PREPARED FOR
CITY OF LAS VEGAS

BID # BSL3 LAB
 DATE: 5/10/2024

MWA # #####
 DESIGNED BY: KC

SUBMITTAL STAGE:
 50% DD

DRAWN BY: KC
 CHECKED BY: VB

SHEET
C-04
 8
 8
 DRAWING NO.
 #####

H:\19300\BLS3 - EWING COLE - SNHD BSL3 LAB VEGAS ENGINEERING\AN\PUBLIC IMPROVEMENT\PLANS\CIP SNHD LAB PUBLIC IMP - SD PROFILE.DWG
 5/10/24